



Airstream International Range

Inspiring adventure for more than 85 years.

In 1931, Airstream began with a dream: to create lightweight travel trailers that slipped cleanly through the wind. And with it was born another dream, one of new freedoms, new places, new experiences and new friendships. It was a dream so powerful and enduring that it did far more than create a new way to travel; it created a way of life shared by thousands upon thousands of families.

This latest fleet of Airstream Travel Trailers continues the tradition of extraordinary design and hand-crafted quality that has made Airstream world famous.

Following our founder Wally Byam's credo, "Let's not make changes, let's make only improvements," this fleet offers the latest technology advancements and conveniences in a way that is distinctly Airstream.

With travel trailers perfect for everyone from first-timers to seasoned Airstreamers you're sure to find one ideal for the adventure that awaits you around the next bend!



Bob Wheeler
President & CEO
Airstream, Inc.



Live Riveted

Dream. Travel. Explore. Live.

Living riveted is about discovery. Not just of new places and spaces, but also of people and ourselves. It's the drive to open a whole new world of experiences.

So awaken your venturesome spirit. Come alive. Be passionate, engaged, and present in every moment. Live Riveted.









A moveable feast for the eyes in an open environment that will take your breath away.

Take a calming breath, relax and sense the space, harmonious design built to calm the spirit. Every interior shape, surface and colour designed to soothe the mind and body.

Adventure? Excitement? While you're sure to experience these when travelling with your Airstream, those who also seek quiet sanctuary, where they can rest and reflect, will surely discover what they desire.



Missouri



Yukon



Colorado





Its sophisticated stylish design, with Corian® work surfaces, premium fabrics, rich colours and plush leather seating. Thoughtfully concealed storage adds an element of practicality and functionality to a premium design. The effect? A feeling of relaxed modernism, a perfect fit for the iconic Airstream.



Manhattan Leather



Manhattan Impala



Americana Leather









Floorplans

Missouri

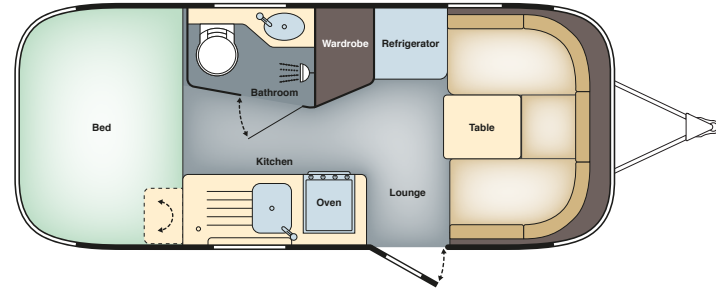

Yukon

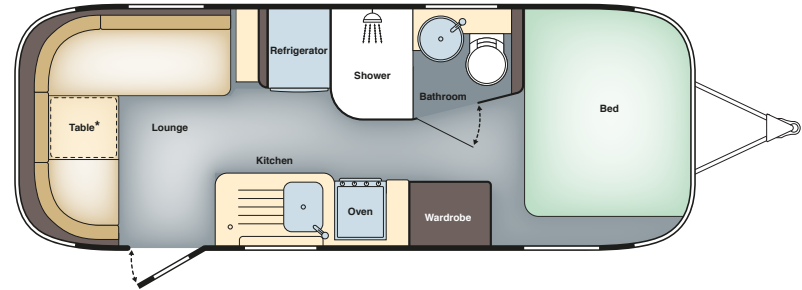

*Table transforms to become the base for the L-shaped seating arrangement.

Colorado

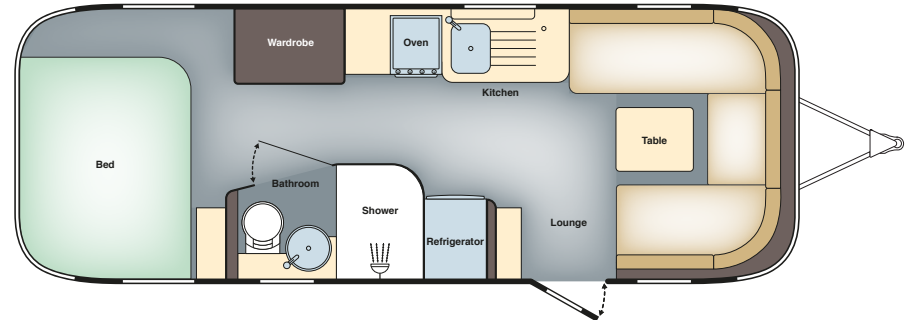

Specifications

Specifications	Missouri	Yukon	Colorado
Berths	4	2 / 3	4
Axles	1	2	2
Internal Length	5.32m	6.03m	6.81m
Overall Length*	6.81m	7.60m	8.25m
Overall Width*	2.29m	2.29m	2.50m
Overall Height*	2.65m	2.65m	2.65m
Internal Headroom	1.99m	1.99m	1.99m
Mass in Running Order	1645kg	1900kg	2165kg
Maximum Technical Permissible Laden Mass (MTPLM)	1830kg	2100kg	2400kg
Total User Payload	190kg	230kg	265kg
Personal Effects	145.0kg	153.0kg	159.0kg
ZipDee® Awning	40.0kg	40.0kg	40.0kg
Optional Upgraded MTPLM	1900kg	2680kg	2680kg
Tyre Size	205/70 R15C 106 R	185/60 R15C 94 T	185/60 R15C 94 T
Hitch Limit	150kg	150kg	150kg

Bed Sizes	Missouri	Yukon	Colorado
Front Double	1.99m x 1.24m	1.85m x 1.41m	2.19m x 1.37m
Rear Double	1.85m x 1.41m	-	1.85m x 1.41m

The Mass in Running Order (MRO) comprises:

1. The mass of the empty caravan as supplied by Swift including loose items such as the hook-up cable, kit bag, manuals etc
2. 19.8kg allowance for LPG
3. 35kg allowance for water in the fresh water tank.
4. 8.4kg allowance for water in the water heater.

The MRO is calculated with the fresh water tank and boiler full but the toilet flush tank empty. If you travel without water in the fresh water tank the payload can be increased proportionally.

The personal effects is based on the number of berths and the length of the caravan and includes an allowance of 20kg for a leisure battery.

The Maximum Technical Permissible Laden Mass (MTPLM) is the maximum mass allowed when the caravan is fully laden.

WARNING: Under no circumstances should the MTPLM be exceeded.

The masses are calculated in accordance to EU regulation 1230/2012 and NCC code of practice 304.

*The dimensions and weights given are approximate due to slight variations in suspension ride heights, loading conditions and tyre pressures.

Customers should verify the actual dimensions of their touring caravan before committing to anything that could be impacted by these dimensions

Please note: Any dealer fit options will reduce the overall payload available to the user of the caravan. If you require additional payload it is possible to upgrade the MTPLM to the upper limit. Please contact your Airstream dealer for more information.

Features



Stone guard and gas bottle box



ZipDee® Awning



Rear access locker



Batteries on pull out tray



Shoe storage



LED lighting



Control panel



Alde heating



Bluetooth Radio/CD/MP3 player



Corian® work surface



Ecocamel showerhead



Duvalay mattress

Exterior Features

Handcrafted buck riveted aluminium bodyshell, timeless iconic design

Rounded aerodynamic shape for superior towing performance

Fluoropolymer clearcoated aluminium panels inside and out

Semi-monocoque all aluminium superstructure

Hand crafted Airstream welded extruded aluminium window frames

Tempered tinted windows with double cam latching system

Custom handcrafted 0.66m wide one-piece entry door with window and cast hinges

Hassle free ZipDee® patio awning

Fixed aluminium 'Thule' entrance step

European specification chassis with overrun brakes and composite insulated floor

Thermal barrier protection between interior and exterior

Temperature reducing one piece white aluminium roof

Use of portal windows to optimise natural light

Stainless steel front stone guard protection

Chrome beltline and rub rail with insert

Polished rear aluminium bumper

Rear registration plate bracket with light

Cast aluminium rear light housings

Stainless steel front and rear grab handles

Aluminium entry door handle

LED entrance door light

Handcrafted aluminium fly screen door

Aluminium LPG gas storage locker

15" Alloy wheels

Spare wheel and tyre including underslung wheel carrier

Exterior access battery box featuring pull out tray with provision for 2 leisure batteries

Exterior under bed access locker with chequer plate lining to floor under bed

Exterior shower with hot and cold water

Exterior gas BBQ connection point

Interior Features

Complete aluminium interior walls and ceiling

Wrap around panoramic front and rear windows

1.99m Internal headroom

Hand crafted Italian Lite-Ply laminated interior cabinetry

Stylish Corian® work surfaces with drain grooves

Choice of 'Americana' or 'Manhattan' leather upholstery schemes

Individually designed seating areas with comfort and functionality in mind

Contemporary rug to lounge area

Duvalay Duvalite mattress with lightweight memory fibre technology

Fully adjustable table with telescopic leg for use with bed make up

Heki rooflights utilised in front and rear

Oceanair Railshade blinds to side windows

Seamless vinyl flooring

Low energy LED interior lighting

Overhead roof lockers with LED accent lighting

Directional LED reading/courtesy lights

Under seating storage access from entrance area

Backrest ventilation boards

Hinged washroom door with frosted window

Corian® kitchen worktop with under counter mounted Franke stainless steel sink & Corian® lid

Corian® bathroom worktop with integral Corian® bowl

Safety and Security

Stabilising tow hitch

Smoke alarm

Carbon monoxide detector

CRiS identity number labels on windows and caravan chassis

Keyed deadbolt locking system

Equipment

ALDE central heating and water heating with LCD touchscreen control with daily programming

Dometic 3 burner cooktop with separate oven and grill

Dometic CK150 extractor above cooker

Sargent EC500 power supply unit with touchscreen control panel

Dometic 110 litre fridge incorporating 12 litre removable freezer compartment (Missouri)

Dometic 190 litre fridge with 35 litre freezer compartment (Yukon & Colorado)

45 litre on-board fresh water tank

Radio/CD/MP3 Player with audio input and Bluetooth capabilities.

Audio speakers set into end roof lockers

Lounge TV station with 230V, 12V and aerial sockets

Bedroom TV station with 12V and aerial socket in bedroom

Status 570 directional aerial

Under locker mounted kitchen roll holder

Size adjustable cutlery tray for optimal use of storage

Centrally heated stainless steel washroom radiator (Yukon & Colorado only)

Brushed steel washroom accessories (model specific)

Ecocamel orbit shower head

12V washroom ventilation fan

Thetford C260 china bowl cassette toilet with electronic flush

Provision for roof mounted air conditioning unit

Provision for roof mounted solar panel

Provision for roof mounted satellite dish (Yukon & Colorado)

Airstream branded entrance mat

13 Pin 'Jaeger' 12v car connector

Aerodynamics and Durability



For our full GREEN story, visit airstream.com

Higher Towing MPG*

The aerodynamic design of Airstream travel trailers contributes up to a 20% advantage in towing efficiency over standard travel trailers.



Lightweight. Streamlined. Fuel efficient.

One part rocket science, two parts common sense. From the beginning, Wally Byam understood the importance of making his Airstream travel trailers easy to tow. After all, Airstreamers are always ready for their next adventure.

A rounded, low-profile shape, paired with strong yet lightweight aluminium, is the trademark of the iconic travel trailers that have become an American cultural legend. Today, true to form, the fuel-efficient travel trailers are nimble and stable on the road, just as they were when they first graced the open road decades ago.

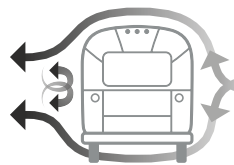

Superior crosswind deflection and lower centre of gravity promote far better stability.

*Actual mileage may vary due to load, driving style, driving conditions, and tow vehicle.

Semi-Monocoque Construction

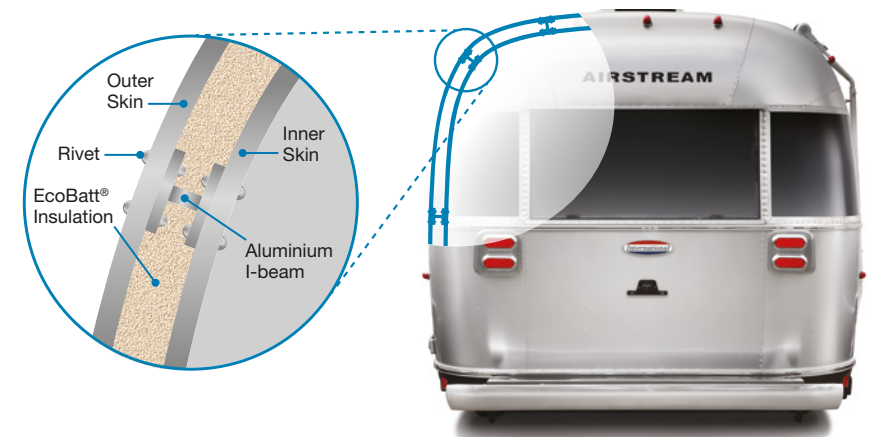

Built with integrity.

You don't get a reputation as the finest in land travel without reason:

Airstream travel trailers are simply built the right way. Superior structural integrity is a result of their semi-monocoque construction, similar to that of an airplane. The result is a durable, lightweight travel trailer.

The aluminium skin, riveted to a solid frame, gives the Airstream its timeless, streamlined shape, and unimpeachable strength.

Specialist Construction

Crafted by hand, for you – over 65% of all Airstreams ever produced are still on the road or in use today. Every Airstream has between 300-400 hours of hand crafted care built in, often passed from generation to generation... 'built to last a lifetime and more'.



Over 3000 rivets are riveted into place by skilled specialists working in pairs



Every Airstream is subjected to extensive, high pressure water testing



Each piece of handcrafted furniture is finished and installed by expert technicians







The Airstream Warranty

At Airstream, we understand the importance of warranty coverage for each travel trailer. Airstream is committed to our company-wide program for continuous quality improvement. We are further committed to using products that conform to all established safety standards, requirements and the reasonable expectations of our customers.

This commitment is backed by our 2 year limited warranty.

LIMITED WARRANTY

Travel Trailer	2 Years; limited, transferable
Structural	2 Years; limited



SWIFT

CONNECT DIRECT

Connect Direct is an online system which personalises each customer's experience of owning their Airstream. Should a problem occur, you will be able to report a fault to us directly, enabling us to react quickly and work together with your dealer to take the problem away from you the owner and resolve the issue as quickly as possible.

This online system provides a direct route for you into the Swift Group, and enables us to provide you with proactive Customer Service support, enhancing your experience.

Connect Direct is in addition to the traditional methods of contacting us.

Visit Us Online

Find travel trailer tips, locate a dealer, learn more about the Airstream community, and discover much more at airstream-uk.co.uk



Live Riveted

Dream. Travel. Explore. Live.

AIRSTREAM

airstream-uk.co.uk

Product information, specifications and photography in this brochure were as accurate as possible at the time of printing. Photographs may contain some features that are options on your vehicle. All props are for photographic purposes only and are not included in the specification.

Since we continually strive to improve our products, actual products may differ. Prices and specification are subject to change without notice. All capacities are approximate and dimensions are nominal.

All content and images
© Airstream and Swift Group

Issued July 2018.

adventure, inspired by
AIRSTREAM

Official UK distributor

